

# LOSS PREVENTION: SECURE FIXTURES

Our intelligent lockable doors ensure that high risk, high value products are secure but remain accessible for genuine customers.

They can be configured to open on a time-delay, or send a message to headsets so that staff are aware that help is required.

Our aim is to display high value, high shrink goods at the lowest possible risk, while still enabling customers to browse and select without waiting for staff to unlock the product. We are leveraging the benefits of Automated Retail solutions to protect high shrink products while encouraging sales by allowing customer access to the products.

**Your self-service and automated technology specialists, providing happier, higher spending shoppers and lower operational costs.**

## Example Benefits

- ▶ **Protect high risk products**
- ▶ **65% reduction in shrink**
- ▶ **Maintain sales & service**
  - Products are visible and accessible to consumers, encouraging sales
  - Increased sales and reduced loss from theft and damage
  - Little or no staff interaction and no expensive tagging system required
  - 65% reduction in shrink for products managed by automation

# 31%

Annual increase in  
SHOPLIFTING offences  
in 2023, to more than  
430,000 incidents

# LOSS PREVENTION: SECURE FIXTURES

We have a wide range of standard secure fixture components, or we can provide you with a custom design if the standard range does not quite meet your requirements.

Get in touch with us to talk about your exact requirements and our friendly sales team will be happy to assist and guide you to ensure that you get the best solution for your needs.

## Specification

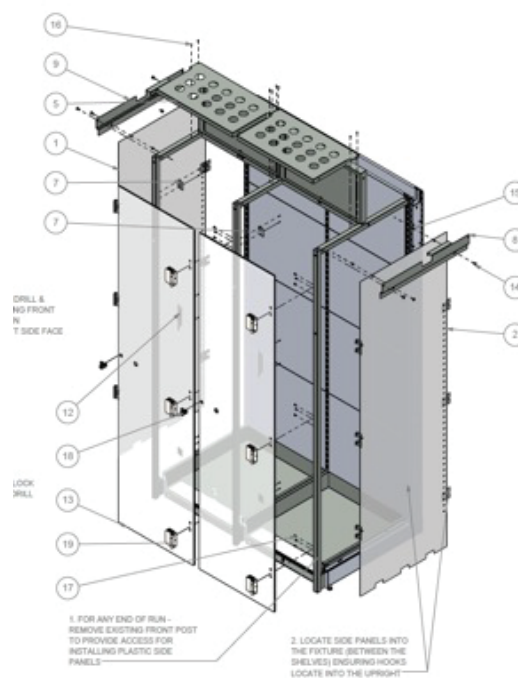

## Key features

- Adds to existing fixture
- Highly durable, 24/7
- Impact resistant
- Various screens formats
- Floor / Wall mounts
- Various screen sizes
- Door / Drawer options
- Integrated PC
- Single / Double sided

**Your self-service and automated technology specialists, providing happier, higher spending shoppers and lower operational costs.**